

SERIE 47

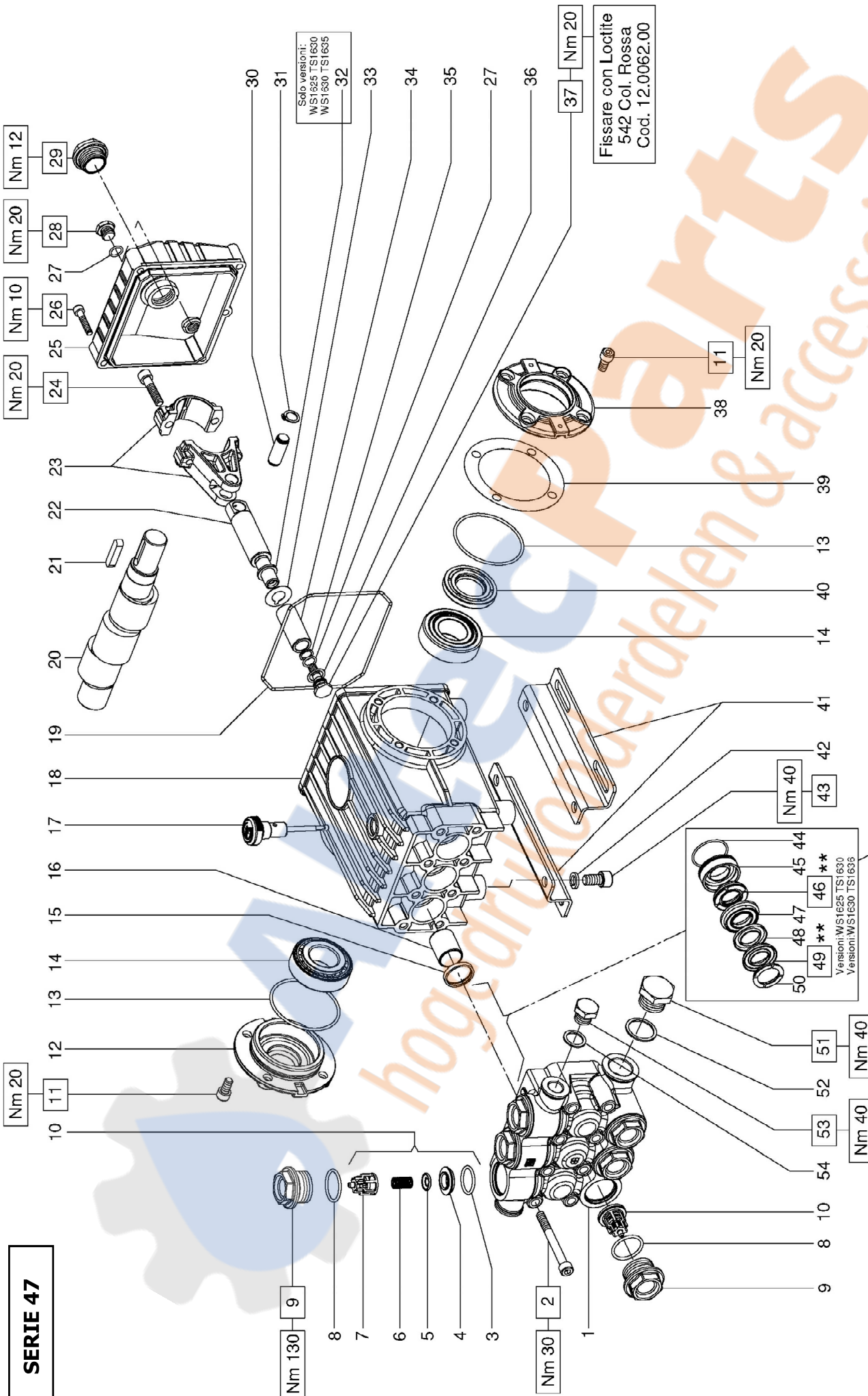

Solo versioni:
WS1625 TS1630
WS1630 TS1635

Fissare con Loctite
542 Col. Rossa
Cod. 12.0062.00

** Lubrificare con grasso di vaselina
** To lubricate with vaseline grease
** Lubrifier avec gras des vaseline
** Sich mit fett zum vaselin schmieren
** Para lubricar con la grasa de vaselina

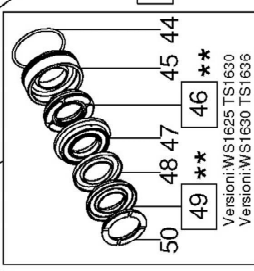
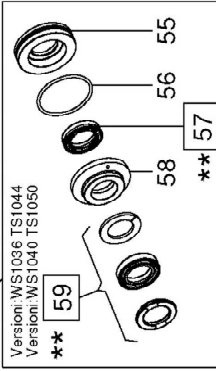

DIS. COD. 47.9540.00

WS1630 - WS1625 - TS1630 - TS1636

POS	COD.	DESCRIZIONE - DESCRIPTION - KIT	NR
1	47.1230.41	Testata D. 22	1
2	99.3220.00	Vite M8x75 UNI 5931	8
3	90.3857.00	OR D. 23.81x2.62 NBR 70SH 132	169
4	36.2033.66	Sede valvola	169
5	36.2034.76	Valvola sferica	169
6	94.7388.00	Molla Dm. 10.0x18.5	169
7	36.2035.51	Guida valvola	169
8	90.3864.00	OR D. 28.25x2.62 NBR 90SH 3112	6
9	98.2300.00	Tappo M32x1.5x17.5	6
10	36.7127.01	Gr. valvola aspiraz. / mand.	169
11	99.3039.00	Vite M8x16 UNI 5931	8
12	47.1511.22	Coperchio laterale	1
13	90.3913.00	OR D. 67.95x2.62 NBR 70SH 3268	2
14	91.8375.00	Cuscinetto a rulli	2
15	90.1625.00	Anello rad. D. 22.0x32.0x5.5	2
16	90.9126.00	Boccola D. 22x25x30	3
17	98.2106.00	Tappo con asta G 3/8"x64	1
18	47.0100.22	Carter pompa	1
19	90.3922.00	OR D.133.02x2.62 NBR 70SH 3525	1
20	47.0217.35 47.0223.35	Alb. Ecc. C.16 - WS1625 TS1630 Alb. ecc. C.19 - WS1630 TS1636	1
21	91.4890.00	Linguetta 8.0x7.0x35.0	1
22	47.0504.66	Guida pistone	3

KIT RICAMBI - SPARE KITS

KIT Nr.	KIT 2	KIT 6	KIT 11	KIT 14	KIT 29	KIT 148	KIT 149	KIT 169
Posizioni include Positions included	15	27 - 33 35 - 36 37	50	44 - 45	44 - 45 46 - 47 48 - 49 50	46 - 48 49	47 - 48	3 - 4 5 - 6 7 (10)
Nr. Pcs.	3	3	6	3	1	3	3	6

POS	COD.	DESCRIZIONE - DESCRIPTION - KIT	NR
23	47.0300.01	Biella completa	3
24	99.3099.00	Vite serraggio biella	6
25	47.1601.22	Coperchio posteriore	1
26	99.1912.00	Vite M6x30 UNI 5931	4
27	90.3585.00	OR D. 10.82x1.78 NBR 70SH 2043	6
28	98.2042.50	Tappo G 1/4"x9 TE17 - Zinc.	1
29	97.5968.00	Spia livello olio G 3/4"	1
30	97.7380.00	Spinotto D. 13x35.5	3
31	90.0557.00	Anello d'arresto A12	6
32	47.2255.70	Distanziale D. 14x20.5x2.5	3
33	96.7286.00	Rosetta D. 14.0x28.0x0.5	6
34	47.0405.09	Pistone D. 22x50	3
35	90.5067.00	Anello antiest. D. 11.0x14.0x1.5	6
36	96.7280.00	Rosetta D. 14.0x18.5x0.5	6
37	47.2195.66	Vite fissaggio pistone	6
38	47.1510.22	Coperchio laterale lato PTO	1
39	97.5678.00	Spessore D. 74.5x104.0x0.1	1
40	90.1648.00	Anello rad. D. 30.0x55.0x7.0	1
41	47.2000.74	Piedino pompa	2
42	96.7106.00	Rosetta D. 10.0x16.0x2.5	4
43	99.3644.00	Vite M10x18 UNI 5931	4
44	90.3616.00	OR D. 34.65x1.78 NBR 70SH 2137	3

POS	COD.	DESCRIZIONE - DESCRIPTION - KIT	NR
45	47.0806.70	Anello di fondo D. 22	14-29
46	90.2728.00	Anello ten. alt. D. 22x35x8.8 LP	29-148
47	47.2170.70	Anello intermedio D. 22	29-149
48	90.2730.00	Anello RESTOP D. 22x35x5.5/2	29-148-149
49	90.2725.00	Anello ten. alt. D. 22x35x7/4.5 HP	29-148
50	46.1000.51	Anello di testa D. 22	11-29
51	98.2268.00	Tappo G 3/4"x16	1
52	96.7700.00	Rosetta D. 26.5x32.0x1.5	1
53	98.2100.00	Tappo G 3/8"x13	1
54	96.7380.00	Rosetta D. 17.5x23.0x1.5	1